



process connections



PROCESS CONNECTIONS - GLASS LEVEL GAUGES WITH GRINDED PIPES AND CYLINDRICAL PLUG COCKS

SHUT OFF COCKS TYPE DS GR18

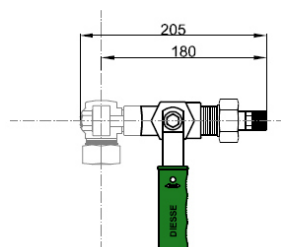

ATTACCHI AL PROCESSO
RUBINETTI FILETTATI M

PROCESS CONNECTIONS
SHUT-OFF COCKS - THREADED M

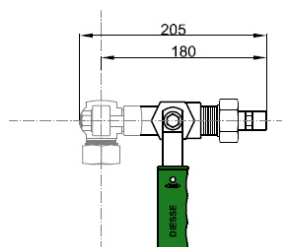

ATTACCHI AL PROCESSO
RUBINETTI FILETTATI F

PROCESS CONNECTIONS
SHUT-OFF COCKS - THREADED F

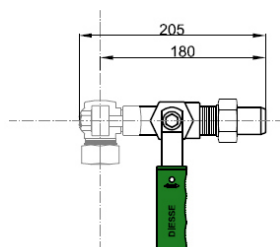

ATTACCHI AL PROCESSO
RUBINETTI BW

PROCESS CONNECTIONS
SHUT-OFF COCKS - BW

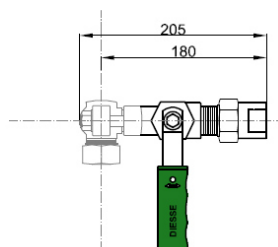

ATTACCHI AL PROCESSO
RUBINETTI SW

PROCESS CONNECTIONS
CUT OFF COCKS - SW

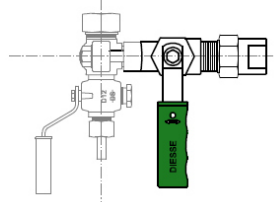
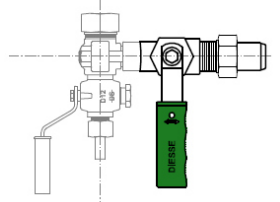
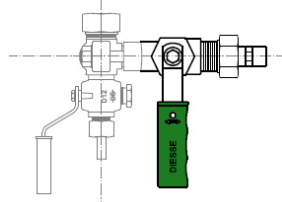
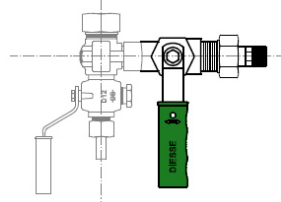

WITHOUT SHUT OFF COCKS

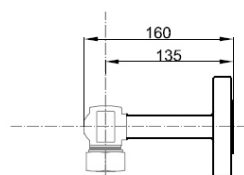

ATTACCHI AL PROCESSO
FLANGIATI

PROCESS CONNECTIONS -
FLANGED

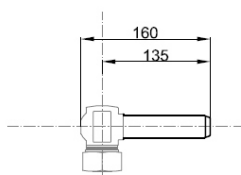

ATTACCHI AL PROCESSO
BW

PROCESS CONNECTIONS -
BW

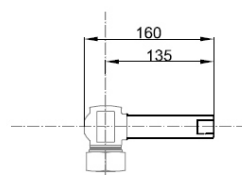

ATTACCHI AL PROCESSO
SW

PROCESS CONNECTIONS -
SW

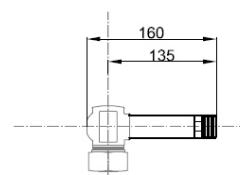

ATTACCHI AL PROCESSO
FILETTATI M

PROCESS CONNECTIONS -
THREADED M

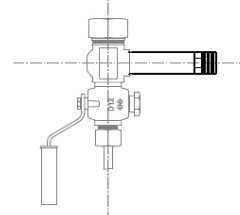
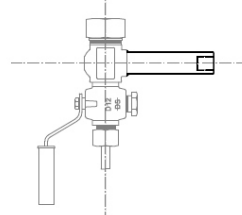
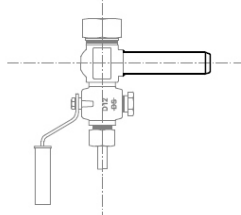
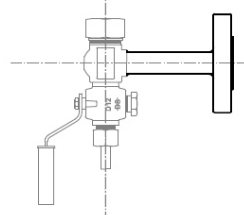

DRAIN AND VENT - GLASS LEVEL GAUGES WITH GRINDED PIPES AND CYLINDRICAL PLUG COCKS

DRAIN for shut off cocks type DS GR18

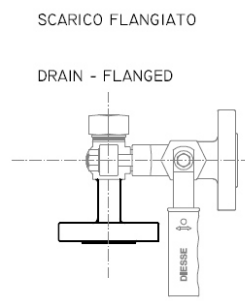
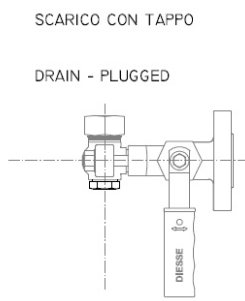
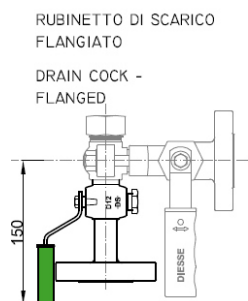
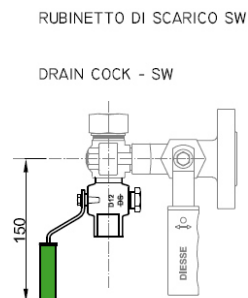
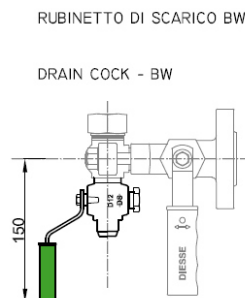
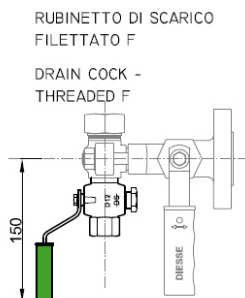
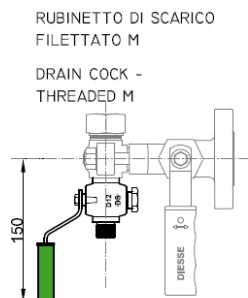

VENT for shut off cocks type DS GR18

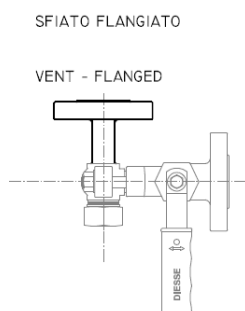
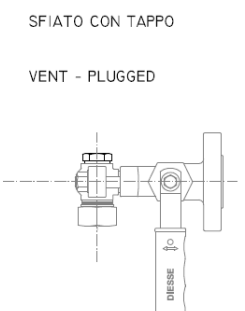
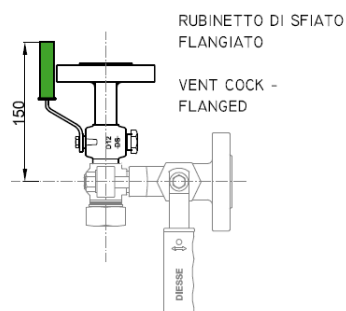
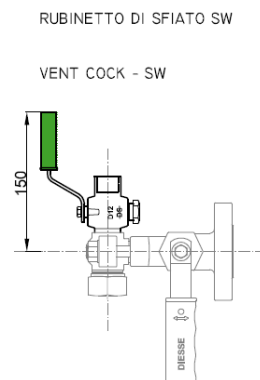
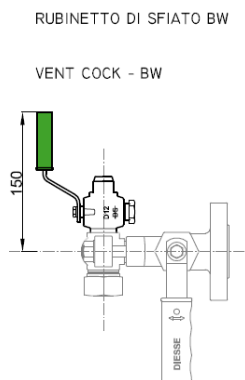
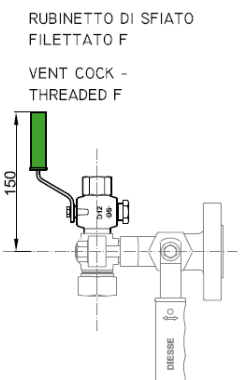
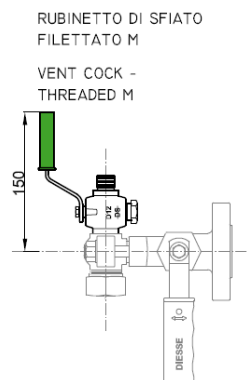

PROCESS CONNECTIONS - GLASS LEVEL GAUGES WITH FIXED DISTANCE BETWEEN CENTERS AND CYLINDRICAL PLUG COCKS

SHUT OFF COCKS TYPE DS GR18

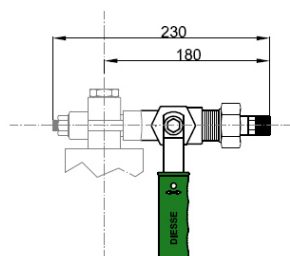

ATTACCHI AL PROCESSO
RUBINETTI FILETTATI M

PROCESS CONNECTIONS
SHUT-OFF COCKS - THREADED M

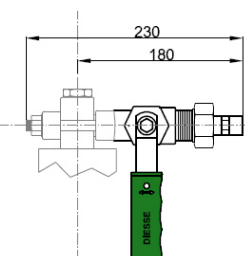
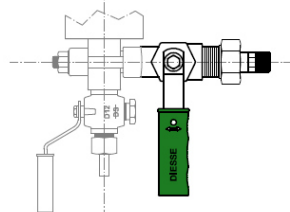

ATTACCHI AL PROCESSO
RUBINETTI FILETTATI F

PROCESS CONNECTIONS
SHUT-OFF COCKS - THREADED F

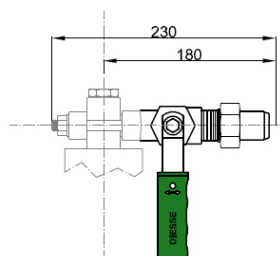
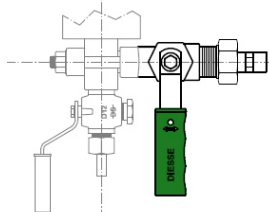

ATTACCHI AL PROCESSO
RUBINETTI BW

PROCESS CONNECTIONS
SHUT-OFF COCKS - BW

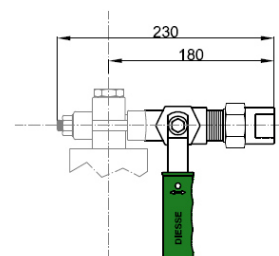
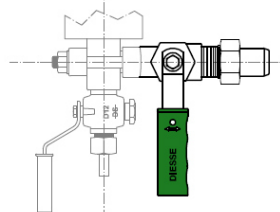

ATTACCHI AL PROCESSO
RUBINETTI SW

PROCESS CONNECTIONS
SHUT-OFF COCKS - SW

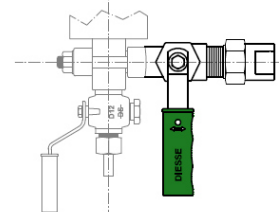

WITHOUT SHUT OFF COCKS

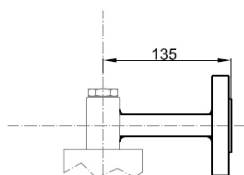

ATTACCHI AL PROCESSO
FLANGIATI

PROCESS CONNECTIONS -
FLANGED

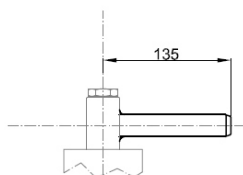
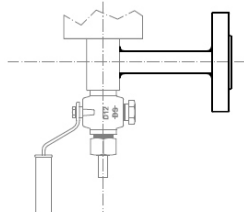

ATTACCHI AL PROCESSO
BW

PROCESS CONNECTIONS -
BW

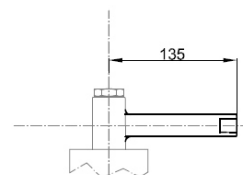
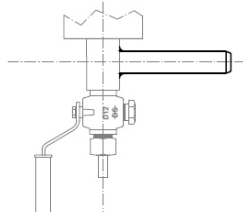

ATTACCHI AL PROCESSO
SW

PROCESS CONNECTIONS -
SW

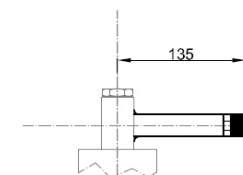
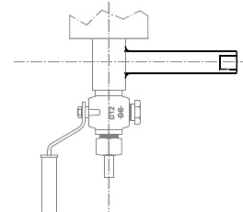

ATTACCHI AL PROCESSO
FILETTATI M

PROCESS CONNECTIONS -
THREADED M

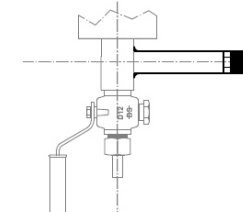

DRAIN AND VENT - GLASS LEVEL GAUGES WITH FIXED DISTANCE BETWEEN CENTERS AND CYLINDRICAL PLUG COCKS

DRAIN for shut off cocks type DS GR18

RUBINETTO DI SCARICO
FILETTATO M

DRAIN COCK -
THREADED M

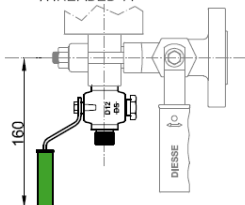

RUBINETTO DI SCARICO
FILETTATO F

DRAIN COCK -
THREADED F

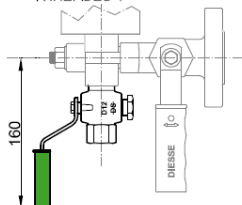

RUBINETTO DI SCARICO BW

DRAIN COCK - BW

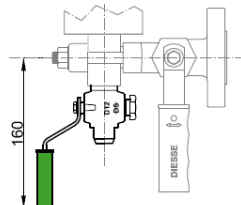

RUBINETTO DI SCARICO SW

DRAIN COCK - SW

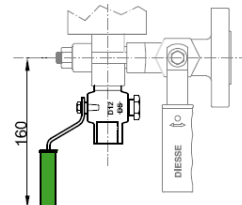

RUBINETTO DI SCARICO
FLANGIATO

DRAIN COCK -
FLANGED

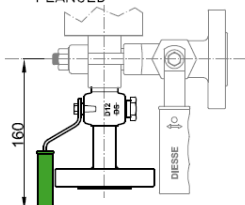

SCARICO CON TAPPO

DRAIN - PLUGGED

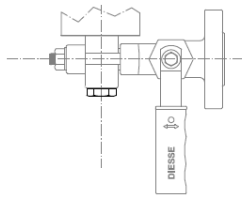

SCARICO FLANGIATO

DRAIN - FLANGED

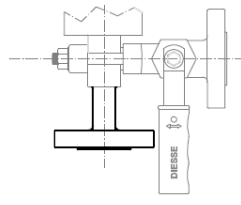

VENT for shut off cocks type DS GR18

RUBINETTO DI SFIATO
FILETTATO M

VENT COCK -
THREADED M

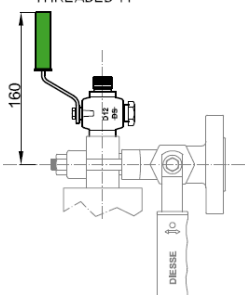

RUBINETTO DI SFIATO
FILETTATO F

VENT COCK -
THREADED F

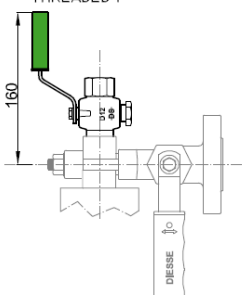

RUBINETTO DI SFIATO BW

VENT COCK - BW

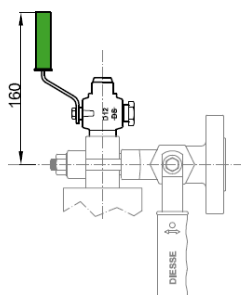

RUBINETTO DI SFIATO SW

VENT COCK - SW

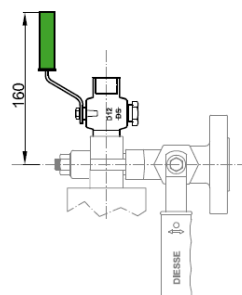

RUBINETTO DI SFIATO
FLANGIATO

VENT COCK -
FLANGED

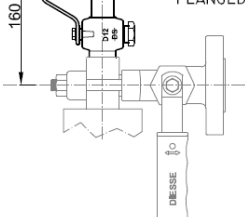

SFIATO FLANGIATO

VENT - FLANGED

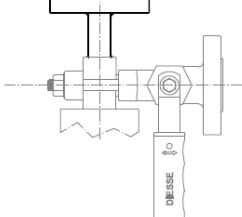

PROCESS CONNECTIONS - GLOBE VALVES

SHUT OFF VALVES TYPE DS SHV for housings with grinded pipes

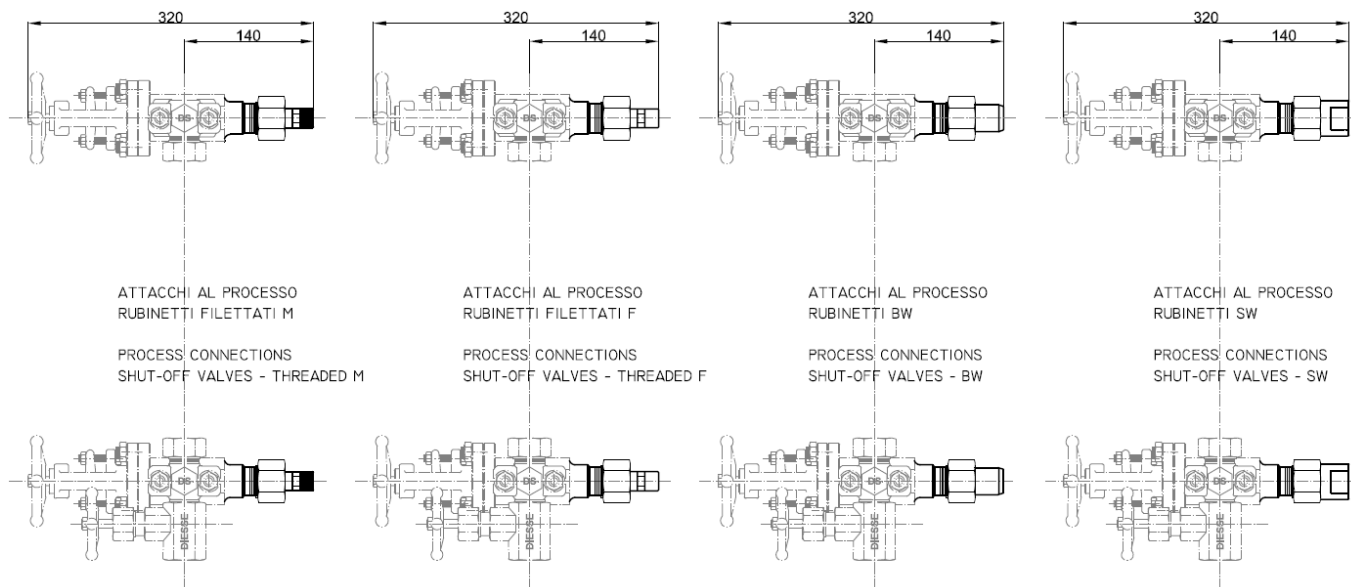

SHUT OFF VALVES TYPE DS SHV for housings with fixed distance between centers

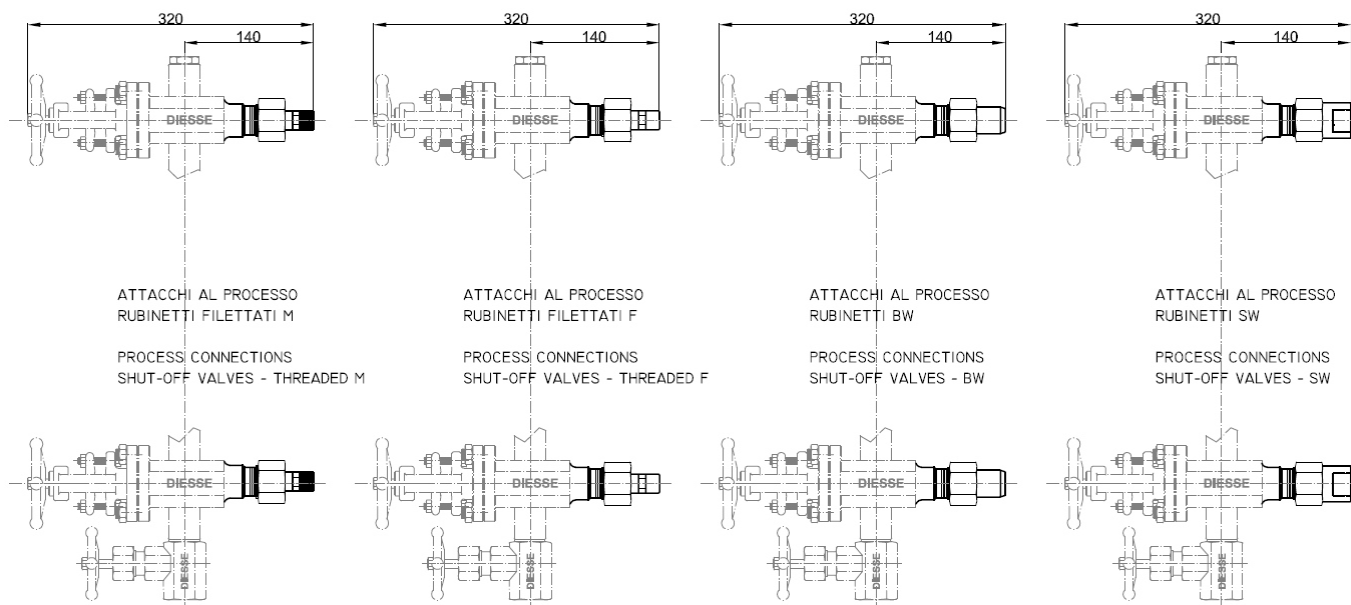

DRAIN AND VENT - GLOBE VALVES

DRAIN for shut off valves type DS SHV for housings with grinded pipes

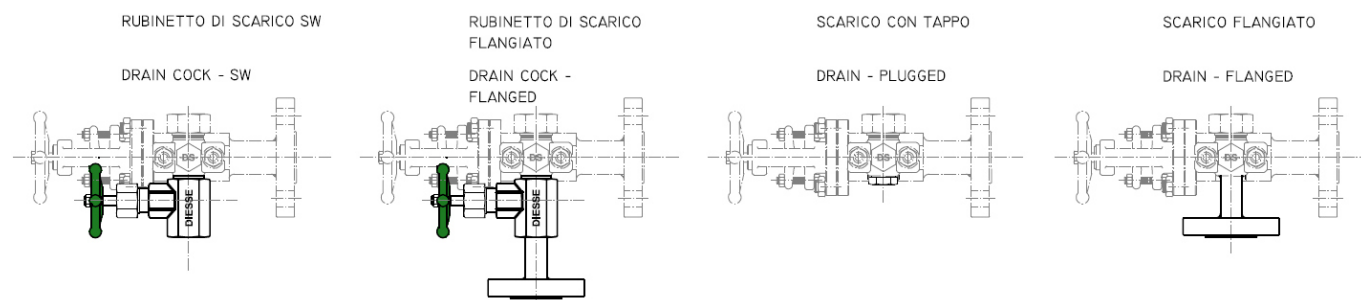

VENT for shut off valves type DS SHV for housings with grinded pipes

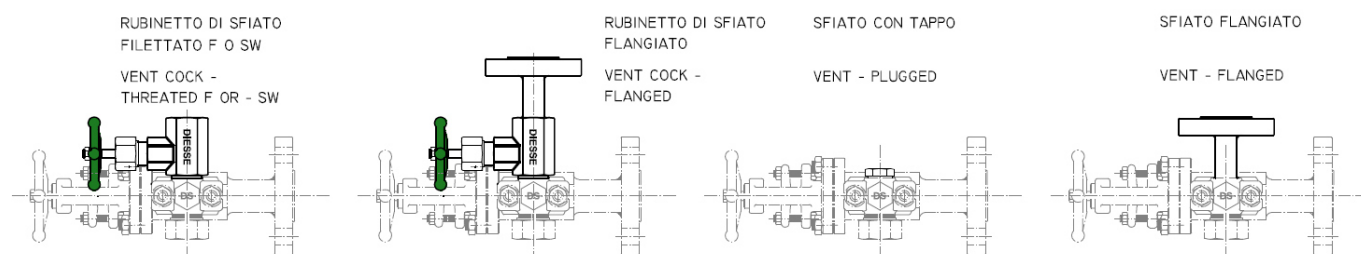

DRAIN for shut off valves type DS SHV for housings with fixed distance between centers

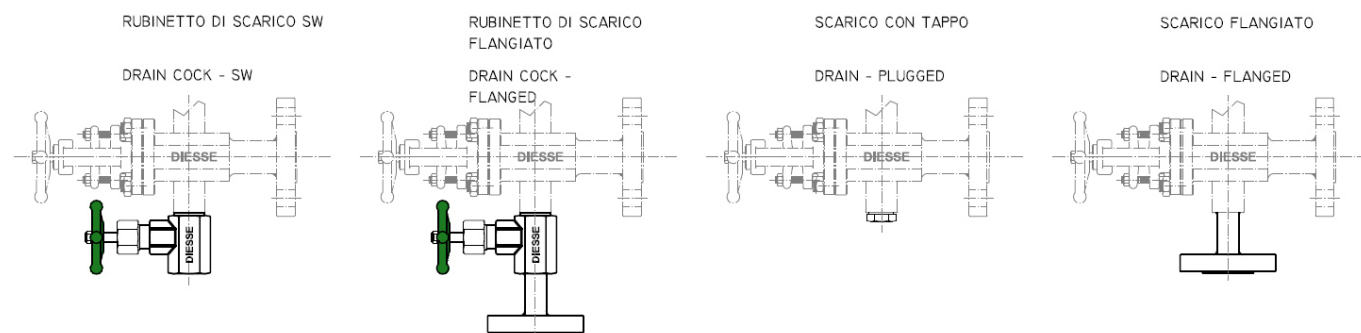

VENT for shut off valves type DS SHV for housings with fixed distance between centers

